

L'ÉCHELLE HO SCALE

AMERICAN LOCOMOTIVE COMPANY  
**RS-11 (DL-701) PRR**

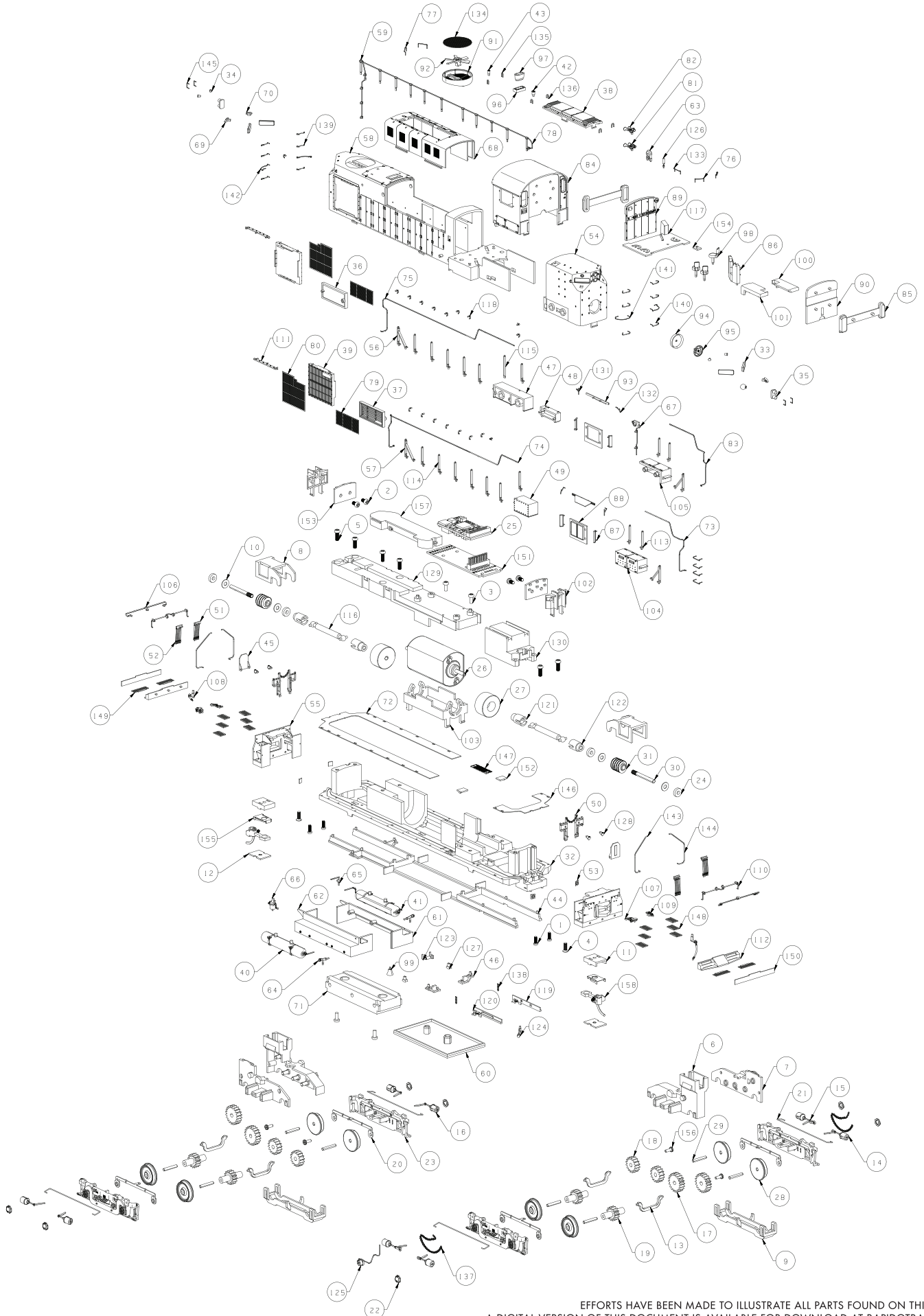

EFFORTS HAVE BEEN MADE TO ILLUSTRATE ALL PARTS FOUND ON THIS MODEL.  
A DIGITAL VERSION OF THIS DOCUMENT IS AVAILABLE FOR DOWNLOAD AT [RAPIDOTRAINS.COM](http://RAPIDOTRAINS.COM).

|       |                  |     |
|-------|------------------|-----|
| 55    | RS11-12-06       | 2   |
| 54    | RS11-11-01       | 1   |
| 53    | RS11-09-20       | 4   |
| 52    | RS11-09-15       | 2   |
| 51    | RS11-09-14       | 2   |
| 50    | RS11-09-10       | 2   |
| 49    | RS11-08-11       | 1   |
| 48    | RS11-08-10       | 1   |
| 47    | RS11-08-09       | 1   |
| 46    | RS11-07-11       | 2   |
| 45    | RS11-07-08       | 2   |
| 44    | RS11-07-03       | 1   |
| 43    | RS11-06-19       | 1   |
| 42    | RS11-06-17       | 1   |
| 41    | RS11-05-20       | 1   |
| 40    | RS11-05-16       | 1   |
| 39    | RS11-05-14       | 2   |
| 38    | RS11-05-13       | 1   |
| 37    | RS11-05-11       | 1   |
| 36    | RS11-05-10       | 1   |
| 35    | RS11-04-08       | 2   |
| 34    | RS11-04-07       | 4   |
| 33    | RS11-04-06       | 4   |
| 32    | RS11-03-03       | 1   |
| 31    | R1-MT005         | 2   |
| 30    | R1-MT004         | 2   |
| 29    | R1-MT003         | 8   |
| 28    | R1-MT002         | 8   |
| 27    | R1-MT001         | 2   |
| 26    | MOTOR_180_       | 1   |
| 25    | KH01-HO-DCC01    | 1   |
| 24    | BEARING_D2D5HI_5 | 4   |
| 23    | 21-06-11         | 4   |
| 22    | 21-06-07         | 7   |
| 21    | 2-MT004          | 4   |
| 20    | 2-MT001          | 4   |
| 19    | 2-10-03          | 4   |
| 18    | 2-10-02          | 4   |
| 17    | 2-10-01          | 4   |
| 16    | 2-07-10          | 4   |
| 15    | 2-07-09          | 2   |
| 14    | 2-07-08          | 2   |
| 13    | 2-07-07          | 4   |
| 12    | 2-07-06          | 2   |
| 11    | 2-07-05          | 2   |
| 10    | 2-07-04          | 4   |
| 9     | 2-06-04          | 2   |
| 8     | 2-06-03          | 2   |
| 7     | 2-06-02          | 2   |
| 6     | 2-06-01          | 2   |
| 5     | 1-17050DPM       | 6   |
| 4     | 1-17050DFM       | 2   |
| 3     | 1-17040DPM       | 4   |
| 2     | 1-17030DPB       | 4   |
| 1     | 1-14040DPB       | 4   |
| PC NO | PART NAME        | QTY |

|       |             |     |
|-------|-------------|-----|
| 110   | RS18-09-19  | 2   |
| 109   | RS18-09-13  | 2   |
| 108   | RS18-09-11  | 2   |
| 107   | RS18-09-09  | 2   |
| 106   | RS18-09-04  | 2   |
| 105   | RS18-08-14  | 1   |
| 104   | RS18-08-13  | 1   |
| 103   | RS18-07-10  | 1   |
| 102   | RS18-07-07  | 2   |
| 101   | RS18-07-06  | 1   |
| 100   | RS18-07-05  | 1   |
| 99    | RS18-06-15  | 1   |
| 98    | RS18-06-14  | 3   |
| 97    | RS18-06-08  | 1   |
| 96    | RS18-06-07  | 1   |
| 95    | RS18-06-03  | 1   |
| 94    | RS18-06-02  | 1   |
| 93    | RS18-05-21  | 2   |
| 92    | RS18-05-08  | 1   |
| 91    | RS18-05-07  | 1   |
| 90    | RS18-05-02  | 1   |
| 89    | RS18-05-01  | 1   |
| 88    | RS18-04-19  | 2   |
| 87    | RS18-04-18  | 4   |
| 86    | RS18-04-15  | 1   |
| 85    | RS18-04-01  | 2   |
| 84    | RS18-02-06  | 1   |
| 83    | RS11-M099   | 1   |
| 82    | RS11-M074   | 1   |
| 81    | RS11-M065   | 1   |
| 80    | RS11-M058   | 2   |
| 79    | RS11-M057   | 2   |
| 78    | RS11-M056   | 1   |
| 77    | RS11-M055   | 2   |
| 76    | RS11-M054   | 2   |
| 75    | RS11-M053   | 1   |
| 74    | RS11-M052   | 1   |
| 73    | RS11-M051   | 1   |
| 72    | RS11-M047   | 1   |
| 71    | RS11-21-05  | 1   |
| 70    | RS11-20-14  | 2   |
| 69    | RS11-20-13  | 2   |
| 68    | RS11-19-03  | 1   |
| 67    | RS11-17-19  | 1   |
| 66    | RS11-17-11  | 1   |
| 65    | RS11-17-10  | 1   |
| 64    | RS11-17-05  | 2   |
| 63    | RS11-17-04  | 1   |
| 62    | RS11-16-09  | 1   |
| 61    | RS11-16-08  | 1   |
| 60    | RS11-16-07  | 1   |
| 59    | RS11-15-01  | 1   |
| 58    | RS11-14-01  | 1   |
| 57    | RS11-13-07R | 2   |
| 56    | RS11-13-07L | 2   |
| PC NO | PART NAME   | QTY |

|       |                |     |
|-------|----------------|-----|
| 158   | YYMX-HCP03     | 2   |
| 157   | YYMS-SPH02     | 1   |
| 156   | SCREW_1_4X4_CB | 4   |
| 155   | RTR301-MT001   | 2   |
| 154   | RS18-PCB07     | 1   |
| 153   | RS18-PCB04     | 2   |
| 152   | RS18-PCB03     | 2   |
| 151   | RS18-PCB01     | 1   |
| 150   | RS18-M094      | 2   |
| 149   | RS18-M093      | 4   |
| 148   | RS18-M091      | 12  |
| 147   | RS18-M086      | 1   |
| 146   | RS18-M080      | 1   |
| 145   | RS18-M067      | 4   |
| 144   | RS18-M049      | 2   |
| 143   | RS18-M048      | 2   |
| 142   | RS18-M046      | 2   |
| 141   | RS18-M045      | 2   |
| 140   | RS18-M044      | 6   |
| 139   | RS18-M043      | 6   |
| 138   | RS18-M042      | 2   |
| 137   | RS18-M041R     | 2   |
| 136   | RS18-M021      | 4   |
| 135   | RS18-M019      | 2   |
| 134   | RS18-M018      | 1   |
| 133   | RS18-M015      | 5   |
| 132   | RS18-M006      | 2   |
| 131   | RS18-M005      | 2   |
| 130   | RS18-21-02     | 1   |
| 129   | RS18-21-01     | 1   |
| 128   | RS18-20-10     | 4   |
| 127   | RS18-20-05     | 2   |
| 126   | RS18-18-21     | 1   |
| 125   | RS18-18-20     | 1   |
| 124   | RS18-18-11     | 1   |
| 123   | RS18-18-10     | 1   |
| 122   | RS18-17-21     | 2   |
| 121   | RS18-17-20     | 2   |
| 120   | RS18-17-15     | 1   |
| 119   | RS18-17-14     | 1   |
| 118   | RS18-17-01     | 18  |
| 117   | RS18-16-18     | 1   |
| 116   | RS18-13-11     | 2   |
| 115   | RS18-13-09     | 1   |
| 114   | RS18-13-08R    | 9   |
| 113   | RS18-13-08L    | 8   |
| 112   | RS18-12-02     | 2   |
| 111   | RS18-10-05     | 2   |
| PC NO | PART NAME      | QTY |