



# PACIFIC CAR & FOUNDRY B-70-69/71/75 BOXCAR

Thank you for purchasing the Pacific Car & Foundry B-70-69/71/75 boxcar from Rapido Trains, Inc. Please note that the recommended minimum radius for these cars is 18 inches. Be sure to give your model a quick inspection to ensure that the couplers are working correctly and the wheels are in gauge before putting it on your layout.

## PROTOTYPE HISTORY

As the demand grew in the 70s for larger capacity boxcars, along with the need to replace aging 40' cars, this series of 50' double door boxes was produced by PC&F for the Southern Pacific and its subsidiary St. Louis Southwestern (SSW). Constructed between 1972 and 1975, these boxcars are 50'-7" in length with a capacity of either 5258 cu ft for standard cars, or 5119 cu ft for those equipped for DF (Damage Free) Loading. All B-70 boxcars feature Hydra-Cushion underframes and were delivered with either Youngstown or Superior doors.

Proving to be a versatile addition to the SP/SSW fleet, these boxcars were later rebuilt for Golden West Service and could be seen carrying goods across the USA, Canada, and Mexico. Many can still be seen on the rails today, whether in their original SSW or SP paint, as former Golden West cars stenciled back into SP, or under entirely new ownership.

## LIMITED WARRANTY

Rapido Trains Inc. will send you any parts found to be missing or defective on this freight car, provided they are available. This warranty does not cover any damage from shipping — including loose parts — that may occur after the car has left our warehouse. It also does not cover unexpected plunges to the train room floor. Please call 1 (855) LRC-6917 or email us at [service@rapidotrains.com](mailto:service@rapidotrains.com).

## HELP AND SUPPORT

Please contact us if you have any problems with your freight car. Also please visit the Product Support section of our web site, as we often address common issues. The Product Support section of our web site also includes an exploded diagram of your car.

## KEEP IN TOUCH

Please visit our web site and click on the link to sign up for our newsletter. That way you will not miss a single new release from Rapido, and we also give you behind-the-scenes information about the world of model railroading. You can also check us out on Facebook and see what we've been up to on our YouTube channel.



CANADA: 500 ALDEN ROAD • UNIT 21 • MARKHAM • ONTARIO • L3R 5H5  
USA: PO BOX 796 • HIGGANUM • CONNECTICUT • 06441  
Tel. 905.474.3314. Fax. 905.474.3325. Visit. [www.rapidotrains.com](http://www.rapidotrains.com)

**RAPIDO**

HO SCALE

PACIFIC CAR & FOUNDRY

# B-70-69/71/75 Boxcar

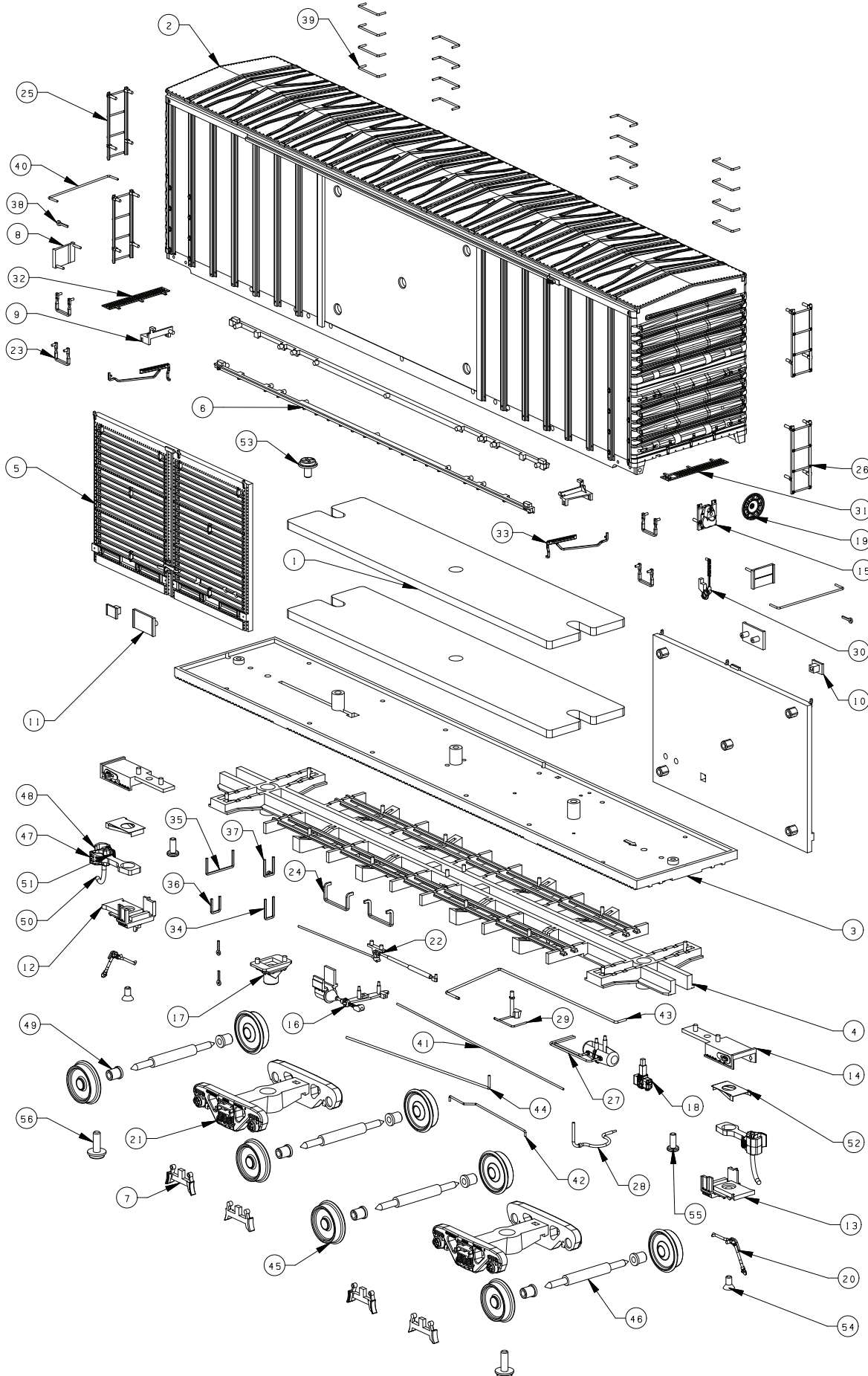

56	SCREW 1.7x5PWb	2
55	SCREW 1.4x3.5CB	2
54	SCREW 1.4x3KB	2
53	SCREW 17xPWb	1
52	GF-MT012	2
51	GF-MT008	2
50	GF-MT007	2
49	GF-08-02	8
48	GF-06-02	2
47	GF-06-01	2
46	5A-MT003	4
45	5A-MT001	8
44	170-MT014	1
43	170-MT013	1
42	170-MT012	1
41	170-MT011	1
40	170-MT010	2
39	170-MT009	16
38	170-MT008	4
37	170-MT007	1
36	170-MT006	1
35	170-MT005	1
34	170-MT004	1
33	170-MT003	2
32	170-MT002	1
31	170-MT001	1
30	170-05-10	1
29	170-05-09	1
28	170-05-08	1
27	170-05-07	1
26	170-05-06	2
25	170-05-05	2
24	170-05-04	2
23	170-05-03	4
22	170-05-02	1
21	170-05-01	2
20	170-04-14	2
19	170-04-13	1
18	170-04-12	1
17	170-04-11	1
16	170-04-10	1
15	170-04-09	1
14	170-04-08	2
13	170-04-07	1
12	170-04-06	1
11	170-04-05	2
10	170-04-04	2
9	170-04-03	2
8	170-04-02	2
7	170-04-01	4
6	170-03-06	2
5	170-03-01	2
4	170-02-02	1
3	170-02-01	1
2	170-01-1	1
1	133-MT009	2

EFFORTS HAVE BEEN MADE TO ILLUSTRATE ALL PARTS FOUND ON THIS MODEL.  
 A DIGITAL VERSION OF THIS DOCUMENT IS AVAILABLE FOR DOWNLOAD AT RAPIDOTRAINS.COM.  
 SHOULD YOU NOT BE ABLE TO LOCATE A SPECIFIC PART, PLEASE CONTACT US FOR ASSISTANCE.

PC NO PART NAME QTY