



GREAT NORTHERN 40 FOOT 12-PANEL BOXCAR

Thank you for purchasing the Great Northern 40' 12-Panel Boxcar from Rapido Trains, Inc. Please note that the recommended minimum radius for these cars is 18 inches. Be sure to give your model a quick inspection to ensure that the couplers are working correctly and the wheels are in gauge before putting it on your layout.

PROTOTYPE HISTORY

The Great Northern Railway built many of its boxcars in its own shops in Saint Cloud, Minnesota. Included in these were two groups of boxcars in 1953 and 1955. These cars had six-foot doors, diagonal panel roof and twelve-panel riveted sides with straight sills. Between the two groups nearly 1000 cars were built.

The first group, series 21450-21939 built in 1953, utilized the then current early improved dreadnaught end. The later 1955 group, series 5000-5499, were built with the updated late improved dreadnaught end – the difference between the two being the main rib shape.

Both groups were delivered in the Great Northern's mineral brown scheme with a large goat herald. Over the years cars from these groups were repainted into the various colorful schemes that the GN developed through the late 1950s and into the 1960s.

LIMITED WARRANTY

Rapido Trains Inc. will send you any parts found to be missing or defective on this freight car, provided they are available. This warranty does not cover any damage from shipping – including loose parts – that may occur after the car has left our warehouse. It also does not cover unexpected plunges to the train room floor. Please call 1 (855) LRC-6917 or email us at service@rapidotrains.com.

HELP AND SUPPORT

Please contact us if you have any problems with your freight car. Also please visit the Product Support section of our web site, as we often address common issues. The Product Support section of our web site also includes an exploded diagram of your car.

KEEP IN TOUCH

Please visit our web site and click on the link to sign up for our newsletter. That way you will not miss a single new release from Rapido, and we also give you behind-the-scenes information about the world of model railroading. You can also check us out on Facebook and see what we've been up to on our YouTube channel.



CANADA: 500 ALDEN ROAD • UNIT 21 • MARKHAM • ONTARIO • L3R 5H5
USA: PO BOX 796 • HIGGANUM • CONNECTICUT • 06441
Tel. 905.474.3314. Fax. 905.474.3325. Visit. www.rapidotrains.com

RAPIDO

HO SCALE

GREAT NORTHERN 40 FOOT 12-PANEL BOXCAR

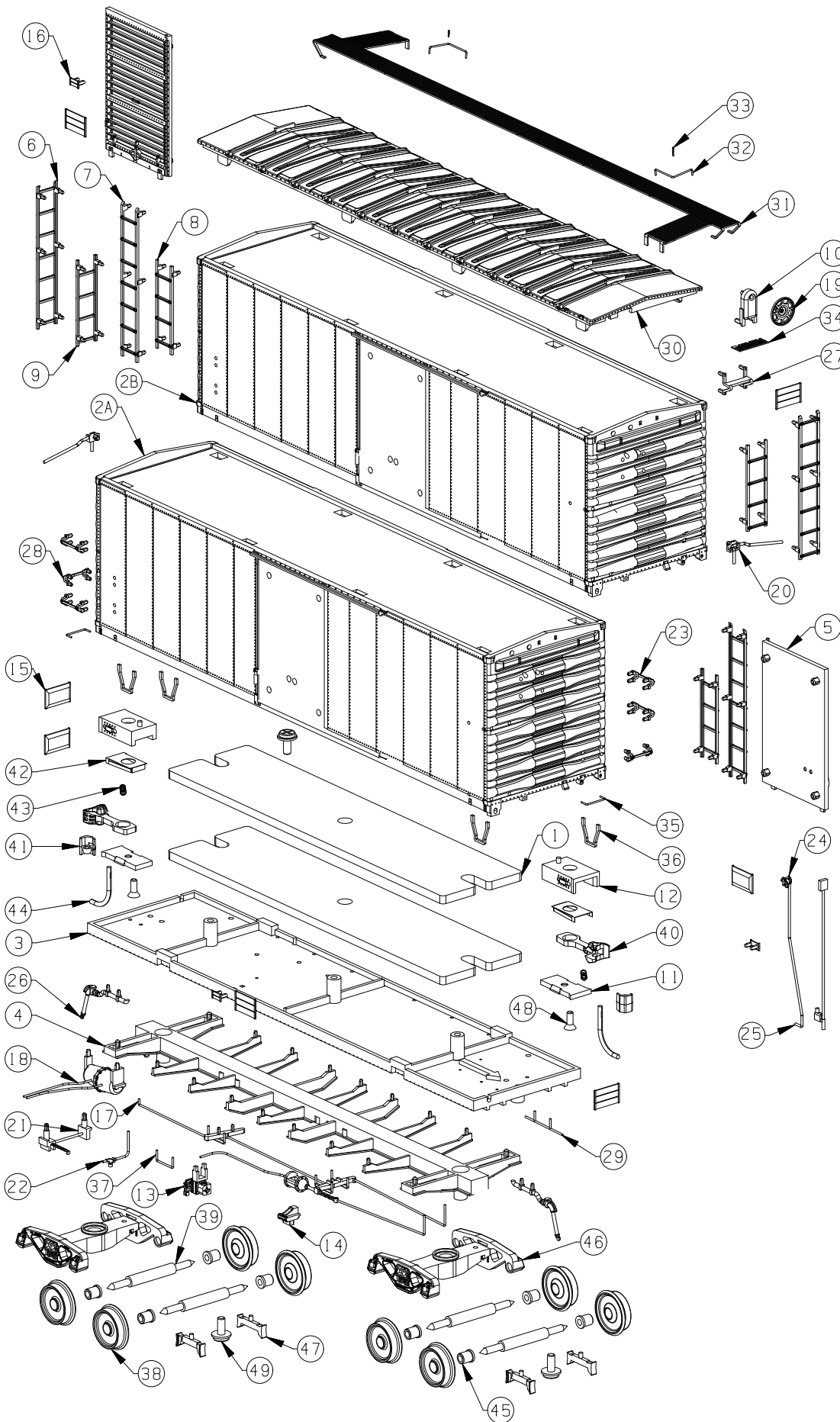

49	SCREW 1.7X4 PWB	3
48	SCREW 1.4X4 KB	2
47	GF-09-04	4
46	GF-09-03	2
45	GF-08-02	8
44	GF-06-M003R1	2
43	GF-06-M002	2
42	GF-06-M001-R1	2
41	GF-06-02	2
40	GF-06-01	2
39	5A-MT003	4
38	5A-MT001	8
37	155-MT007	1
36	155-MT006	4
35	155-MT005	2
34	155-MT004	1
33	155-MT003	2
32	155-MT002	2
31	155-MT001	1
30	154-05-02	1
29	154-04-18	1
28	154-04-17	2
27	154-04-16	1
26	154-04-15	2
25	154-04-13	1
24	154-04-12	1
23	154-04-11	4
22	154-04-10	1
21	154-04-09	1
20	154-04-08	2
19	154-04-03	1
18	154-04-02	1
17	154-04-01	1
16	154-03-17	4
15	154-03-16	8
14	154-03-15	1
13	154-03-14	1
12	154-03-13	2
11	154-03-12	2
10	154-03-07	1
9	154-03-06	2
8	154-03-05	2
7	154-03-04	2
6	154-03-03	2
5	154-03-02	2
4	154-02-02	1
3	154-02-01	1
2B	154-01-04	1
2A	154-01-03	1
1	133-MT009	2

ALL PARTS FOUND ON THIS MODEL CAN BE FOUND ON THIS DRAWING. A DIGITAL VERSION OF THIS DOCUMENT IS AVAILABLE FOR DOWNLOAD AT RAPIDOTRAINS.COM. SHOULD YOU NOT BE ABLE TO LOCATE A SPECIFIC PART, PLEASE CONTACT US FOR ASSISTANCE.

PC NO PART NAME QTY