

# PRR X31A BOXCARS

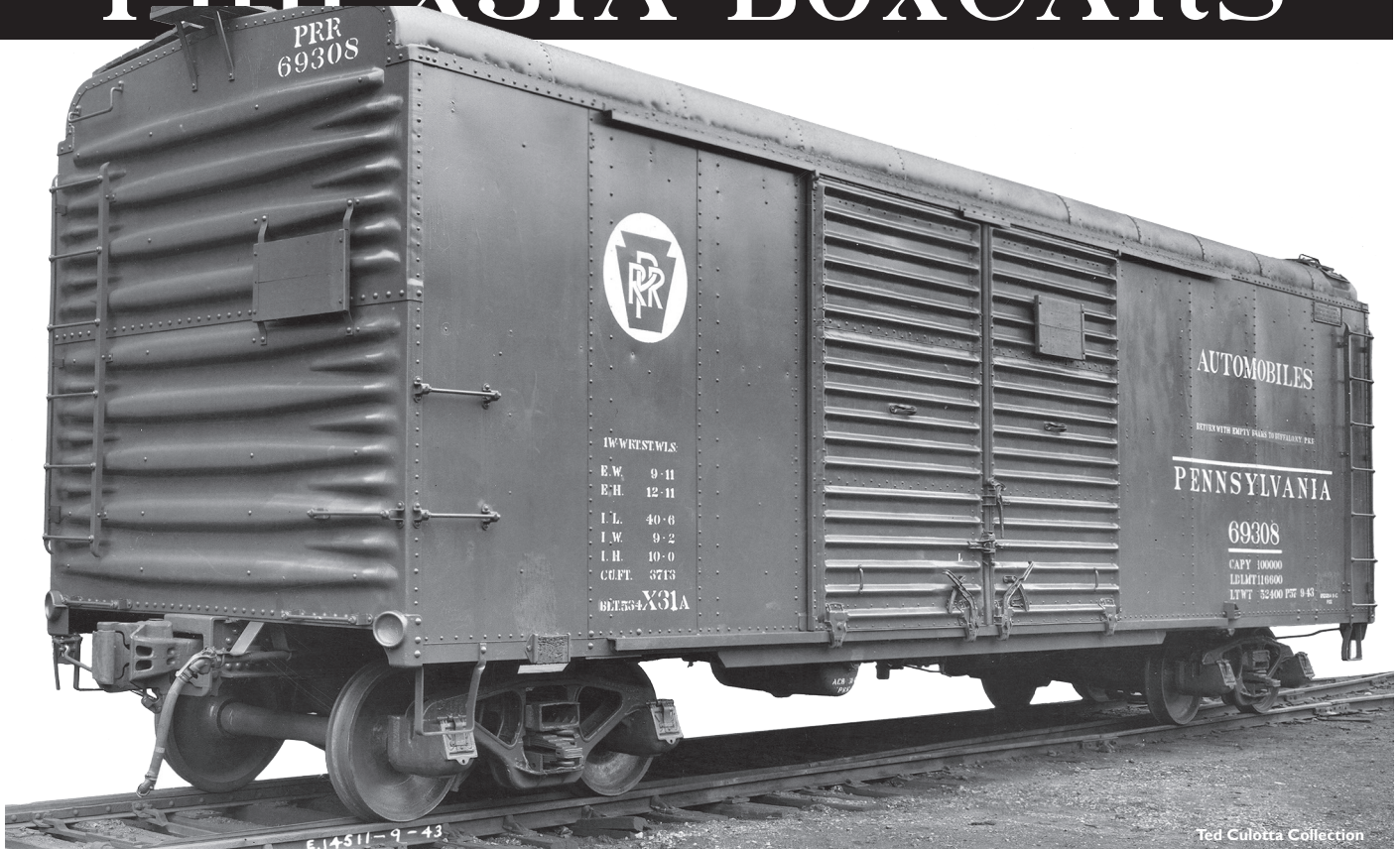

Ted Culotta Collection

Thank you for purchasing Rapido's HO model of the X31A boxcar! These cars feature state-of-the-art tooling with separate grabs, crisp and accurate details and correct PRR class 2D-F12 trucks with free-rolling turned metal wheelsets. Kadee® #158 couplers have been installed on your model.

In 1934 the Pennsylvania Railroad started production of a new series of 40' boxcars – the X31 series. These cars featured an unusual round roof appearance to provide maximum capacity within the then standard loading gauge.

The most numerous group of these new boxcars was the X31A, produced in both single and double door variants. In total, the PRR produced 7200 X31A boxcars, with another 2000 cars being produced to similar classes X31B and X31C. This made the X31 series the second most numerous series of PRR boxcar after 1949. There were more X31 boxcars than many railroads had entire freight cars of all types!

These cars traveled throughout North America and could be seen literally anywhere until the mid 1960s when age and attrition took their toll. Even so, more than 1000 were still in service at the time of the Penn Central merger, though most were retired quickly afterwards.

Following prototype practice, either Equipco and Ajax brake wheels have been installed on your car. The style chosen is based on the most common style for that group of cars. However, since the brake wheels often changed from car to car, we've included the alternate style in the parts bag which can be installed in place of the factory parts if desired.

If there are any factory defects on your boxcar we will do our very best to repair or replace it, subject to the availability of replacements and/or spare parts. Please contact us by phone 1-855-LRC-6917 or go to <https://rapidotrains.com/warranty> and send us an message.

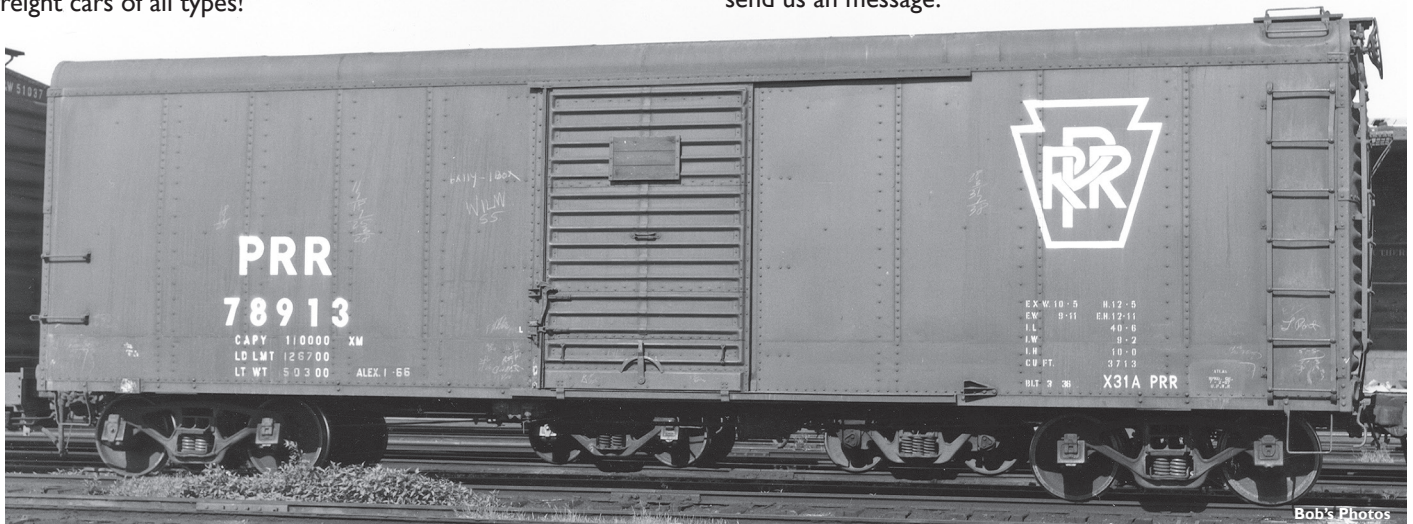

Bob's Photos



CANADA: 500 ALDEN ROAD, UNIT 21 • MARKHAM, ONTARIO • L3R 5H5  
 USA: PO BOX 796 • HIGGANUM • CONNECTICUT • 06441  
 Tel. 1-855-LRC-6917 • Fax. 1-905-474-3325 • Email. [trains@rapidotrains.com](mailto:trains@rapidotrains.com)

**RAPIDO**

# PRR X31A BOXCARS

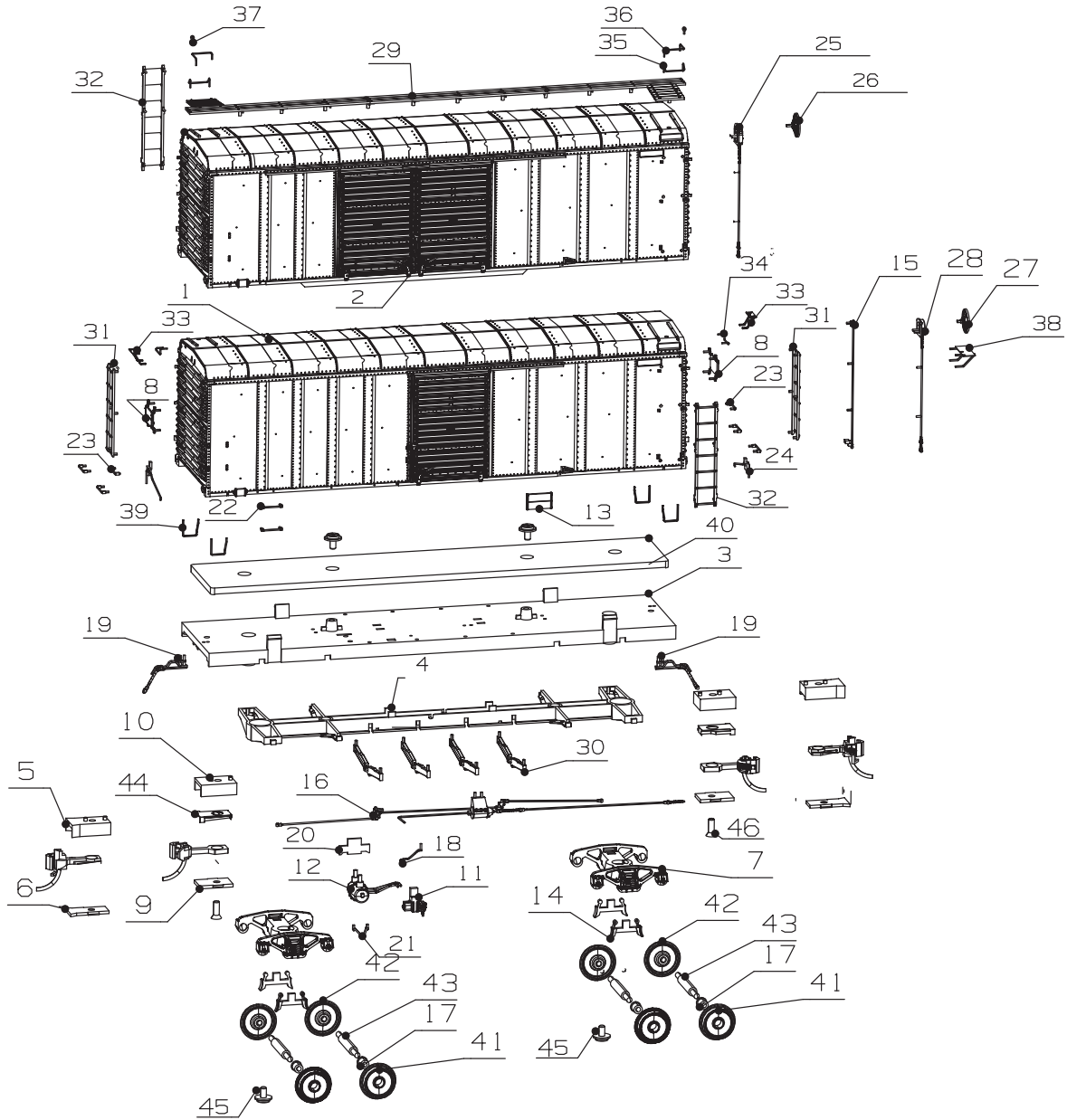

|       |           |     |
|-------|-----------|-----|
| 16    | 123-04-02 | 1   |
| 15    | 123-04-01 | 1   |
| 14    | 123-03-08 | 4   |
| 13    | 123-03-07 | 2   |
| 12    | 123-03-06 | 1   |
| 11    | 123-03-05 | 1   |
| 10    | 123-03-04 | 2   |
| 9     | 123-03-03 | 2   |
| 8     | 123-03-02 | 2   |
| 7     | 123-03-01 | 2   |
| 6     | 123-02-04 | 2   |
| 5     | 123-02-03 | 2   |
| 4     | 123-02-02 | 1   |
| 3     | 123-02-01 | 1   |
| 2     | 123-01-02 | 1   |
| 1     | 123-01-01 | 1   |
| PC NO | PART NAME | QTY |

|       |           |     |
|-------|-----------|-----|
| 32    | 123-05-04 | 2   |
| 31    | 123-05-03 | 2   |
| 30    | 123-05-02 | 4   |
| 29    | 123-05-01 | 1   |
| 28    | 123-04-14 | 1   |
| 27    | 123-04-13 | 1   |
| 26    | 123-04-12 | 1   |
| 25    | 123-04-11 | 1   |
| 24    | 123-04-10 | 2   |
| 23    | 123-04-09 | 2   |
| 22    | 123-04-08 | 8   |
| 21    | 123-04-07 | 1   |
| 20    | 123-04-06 | 1   |
| 19    | 123-04-05 | 2   |
| 18    | 123-04-04 | 1   |
| 17    | 123-04-03 | 4   |
| PC NO | PART NAME | QTY |

|       |                |     |
|-------|----------------|-----|
| 46    | SCREW_1_7X5_KB | 2   |
| 45    | SCREW_1_7X3PWA | 4   |
| 44    | RTR301-MT001   | 2   |
| 43    | 5A-MT003       | 4   |
| 42    | 5A-MT002       | 4   |
| 41    | 5A-MT001       | 4   |
| 40    | 130-MT001      | 1   |
| 39    | 123-M007       | 4   |
| 38    | 123-M006       | 1   |
| 37    | 123-M005       | 2   |
| 36    | 123-M004       | 2   |
| 35    | 123-M003       | 2   |
| 34    | 123-M002       | 2   |
| 33    | 123-M001       | 2   |
| PC NO | PART NAME      | QTY |



CANADA: 500 ALDEN ROAD, UNIT 21 • MARKHAM, ONTARIO • L3R 5H5  
 USA: PO BOX 796 • HIGGANUM • CONNECTICUT • 06441  
 Tel. 1-855-LRC-6917 • Fax. 1-905-474-3325 • Email. trains@rapidotrains.com

**RAPIDO**